

COTTON CANDY MACHINE INSTRUCTIONS

Electrical Requirements

The cotton candy machine requires a 15-amp, 120-volt, 60-cycle standard wall receptacle. The power supply cord is equipped with a machine ground (the tubular prong on the male plug). For safety, always plug the machine into a grounded receptacle, which has been tested for proper polarity to insure electrical safety.

Before Plugging in the Machine

Remove all restraints. Lower the shipping bracket so the bell housing “floats” freely on the springs. Unscrew and push down the two knobs on each side of the cabinet top to lower the shipping bracket completely. Make sure the floss ribbon (heating element) located inside the head assembly has not shaken out of the band during transportation. If the ribbon is out of the band, push it back into place manually.

Controls & Functions

Main switch: Turns motor “on” or “off” and supplies current to the heat switch.

Heat switch: Turns current to the ribbon (heating element) “on” or “off.” (Therefore, both main switch and heat switch must be on for unit to heat.)

Heat control: Increases or decreases voltage to ribbon wire heating element using a graduated dial.

Making Floss

Pick a cone; if it sticks in the stack of cones, twist it off the stack. Hold an inch or two of the pointed end of the cones between two fingers and a thumb. With a light flicking action, roll cone in the web of floss building up in the pan. Lift the cone up with the ring of floss attached and rotate the cone to wrap the floss. **DO NOT** roll floss while the cone is inside the pan. This will pack the floss too tightly. If the floss fails to stick to the cone, pass the cone near the spinner head to pick up a “starter” of melted sugar. Lift the cone out of the pan and wrap the floss with a “figure eight” movement of the hand. This leaves giant pockets and makes the final product appear larger. Make sure room humidity is not too high, or product will be “heavy.”

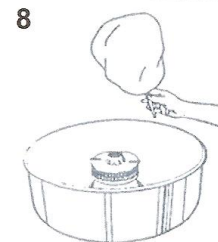
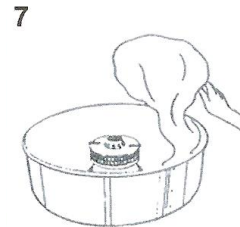
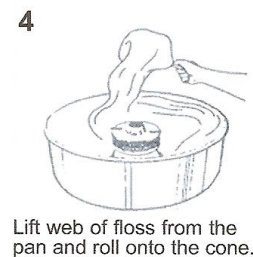
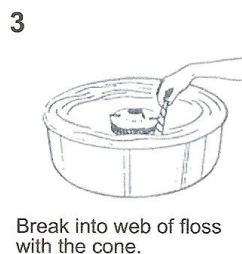
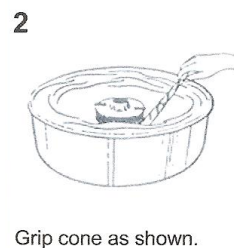
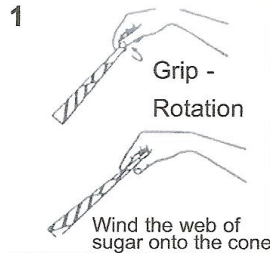

- DO NOT PUT HANDS OR OBJECTS IN ROTATING SPINNER HEAD.
- DO NOT FILL SPINNER HEAD WITH SUGAR WHILE IT IS ROTATING.
- WEAR EYE PROTECTION.
- DO NOT PUT HANDS NEAR ROTATING SPINNER HEAD.
- USE FLOSS CONE TO COLLECT COTTON CANDY.